

# EXTRON MAAP PLATE INSTALLATION INSTRUCTIONS

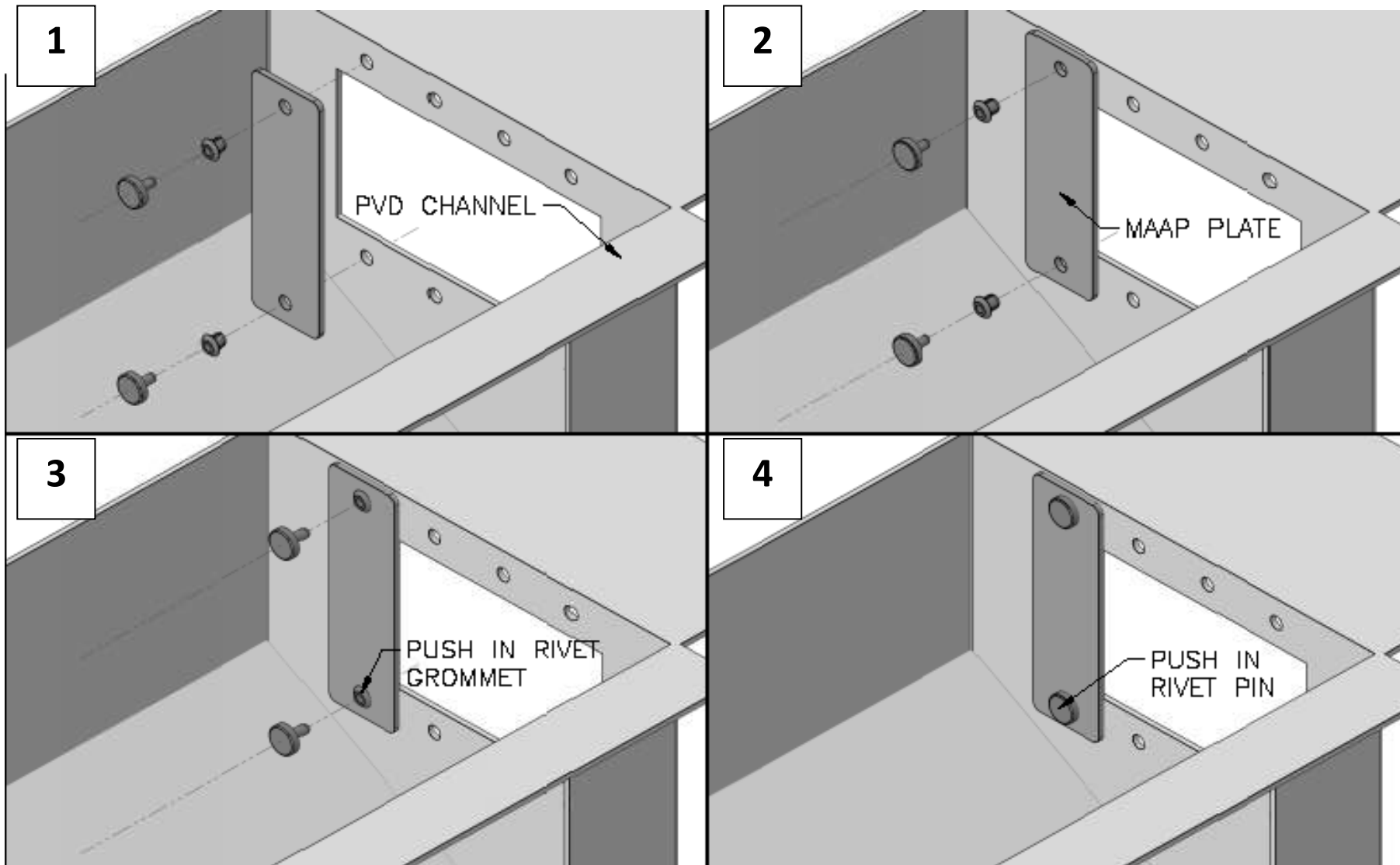

1. GATHER THE MAAP PLATE AND 2 PUSH-IN RIVETS
2. ALIGN MMP PLATE WITH HOLES IN PVD CHANNEL
3. INSERT PUSH IN RIVET GROMMETS THRU MMP PLATE AND PVD CHANNEL
4. FULLY INSERT RIVET PIN INTO RIVET GROMMET